

WALWORTH COUNTY  
SURVEYING & MAPPING  
LAKE GENEVA, WISCONSIN

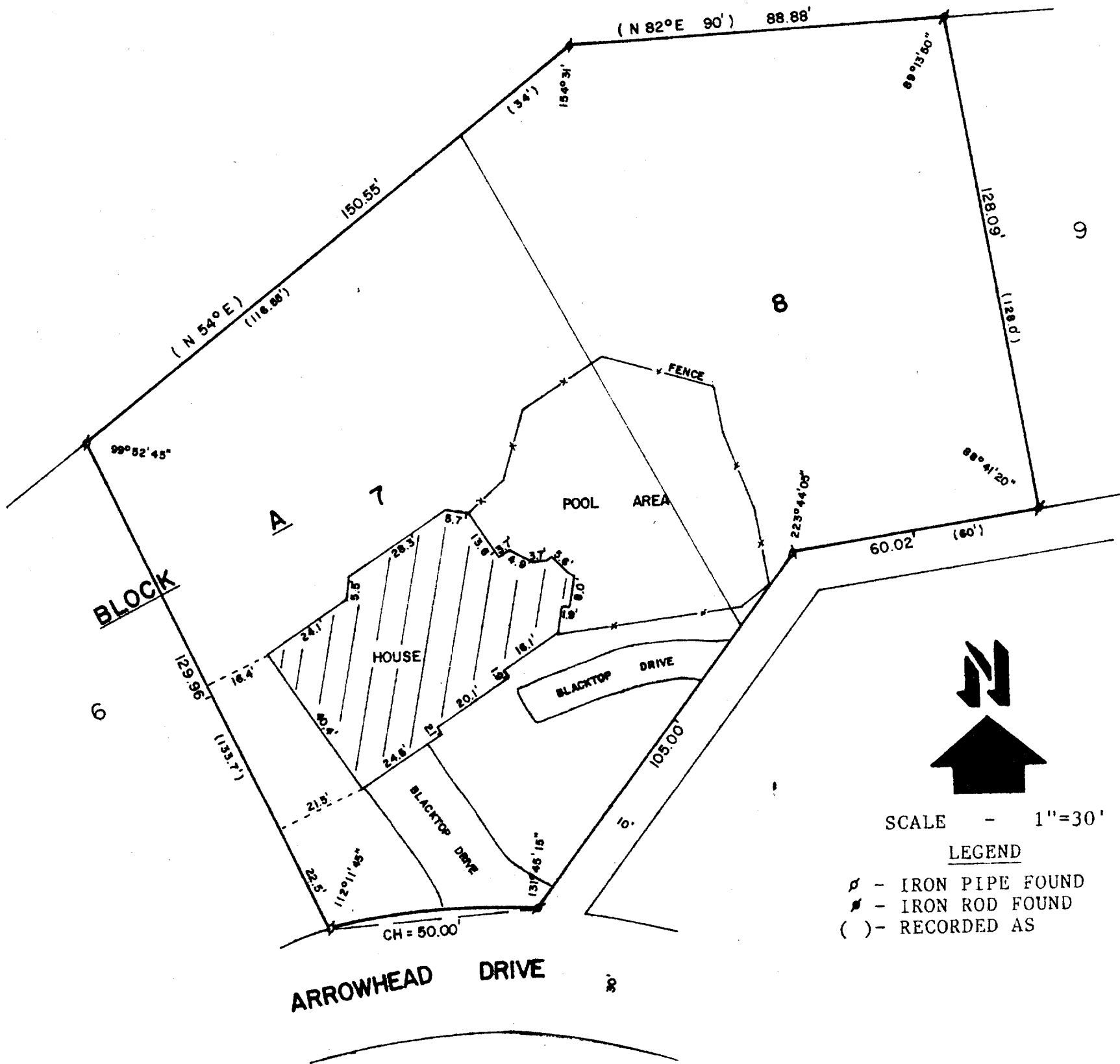

PLAT OF SURVEY OF

LOTS 7 AND 8, BLOCK A, UNIT 3, COUNTRY CLUB ESTATES,  
VILLAGE OF FONTANA-ON-GENEVA LAKE, WALWORTH COUNTY,  
WISCONSIN.

ORDERED BY: COLDWELL BANKER  
838 MAIN ST.  
LAKE GENEVA, WI. 53147

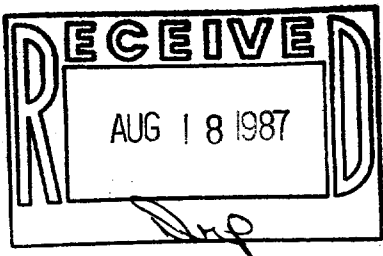

I, ROBERT M. BAERENWALD, DO HEREBY CERTIFY THAT  
I HAVE SURVEYED THE PROPERTY HEREON DESCRIBED  
ACCORDING TO THE OFFICIAL RECORDS AND THAT THE  
PLAT HEREON IS A CORRECT REPRESENTATION OF THE  
PROPERTY LINES TO THE BEST OF MY KNOWLEDGE AND  
BELIEF.

*Robert M. Baerenwald*  
ROBERT M. BAERENWALD  
WISCONSIN REGISTERED LAND SURVEYOR, S-1508

DATE *July 15, 1987* JOB NUMBER - 1150  
NOTE: THIS IS NOT A CERTIFIED COPY UNLESS SEALED.

5-737